

1029

1030

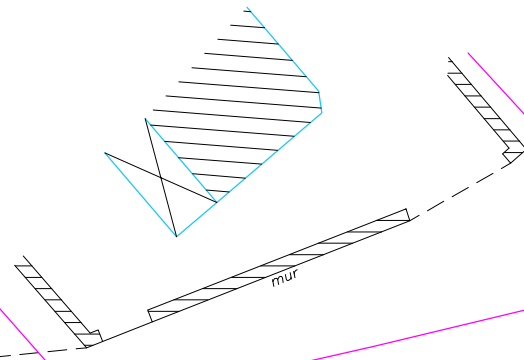

1746

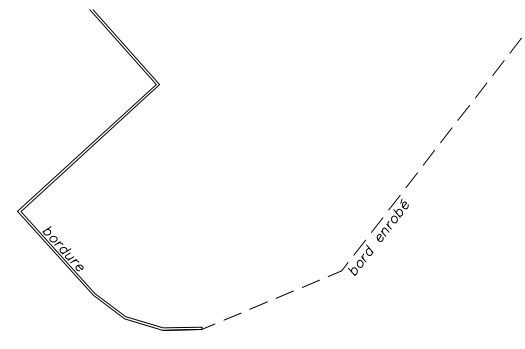

1742

1045

# PLAN DE MASSE

Echelle 1/200

Plan établi sur la base du plan PC2-PLAN MASSE ACCES ET ESPACES VERTS transmis par CODE OUEST le 25.01.2022

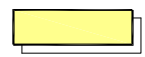
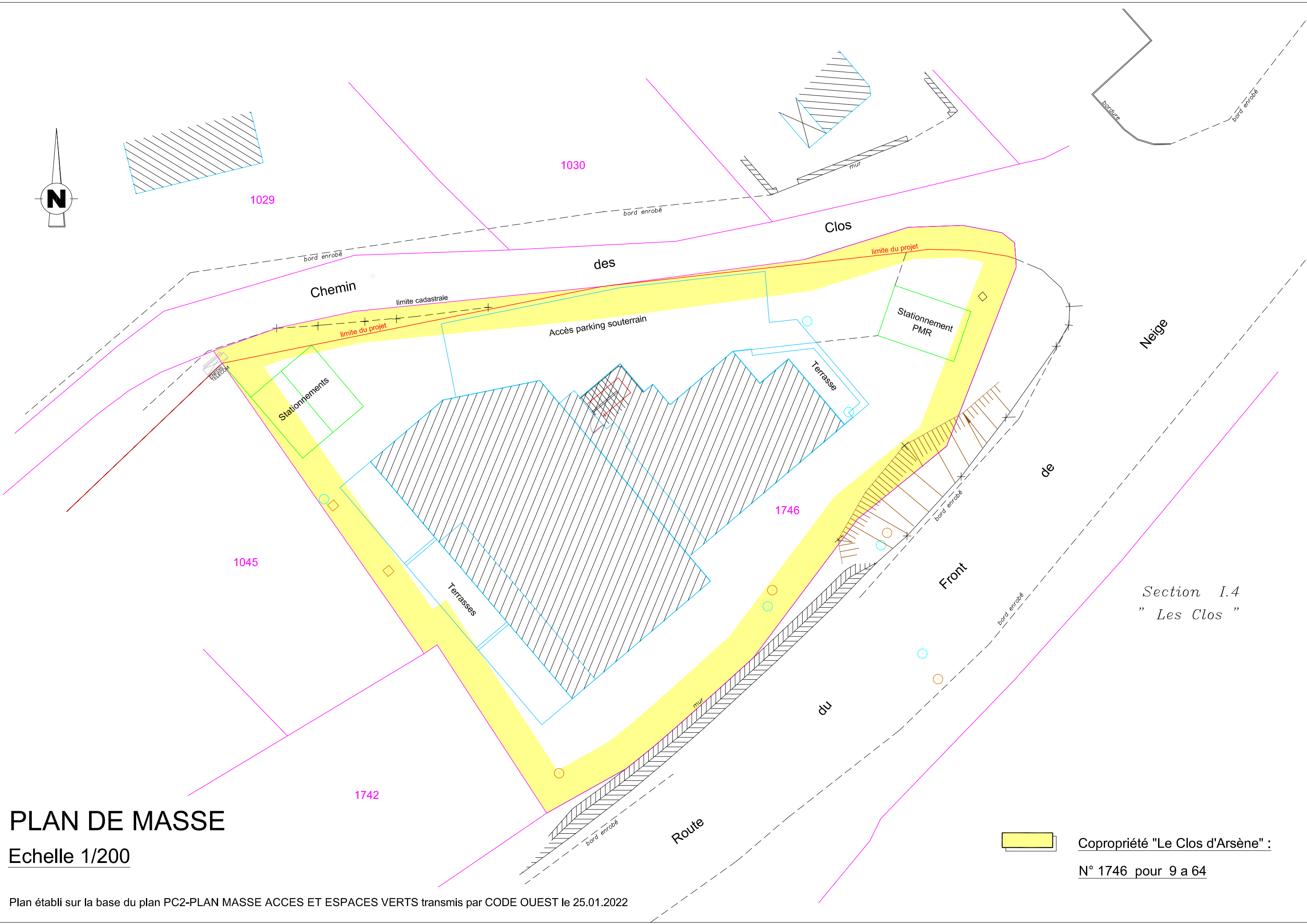

Copropriété "Le Clos d'Arsène" :  
N° 1746 pour 9 a 64

Section I.4  
" Les Clos "